

Der 3-phasige Hybrid

SH5.0RT / SH6.0RT / SH8.0RT / SH10RT

**INSTALLATION & INBETRIEBNAHME
MIT BATTERIE | LG | BYD**

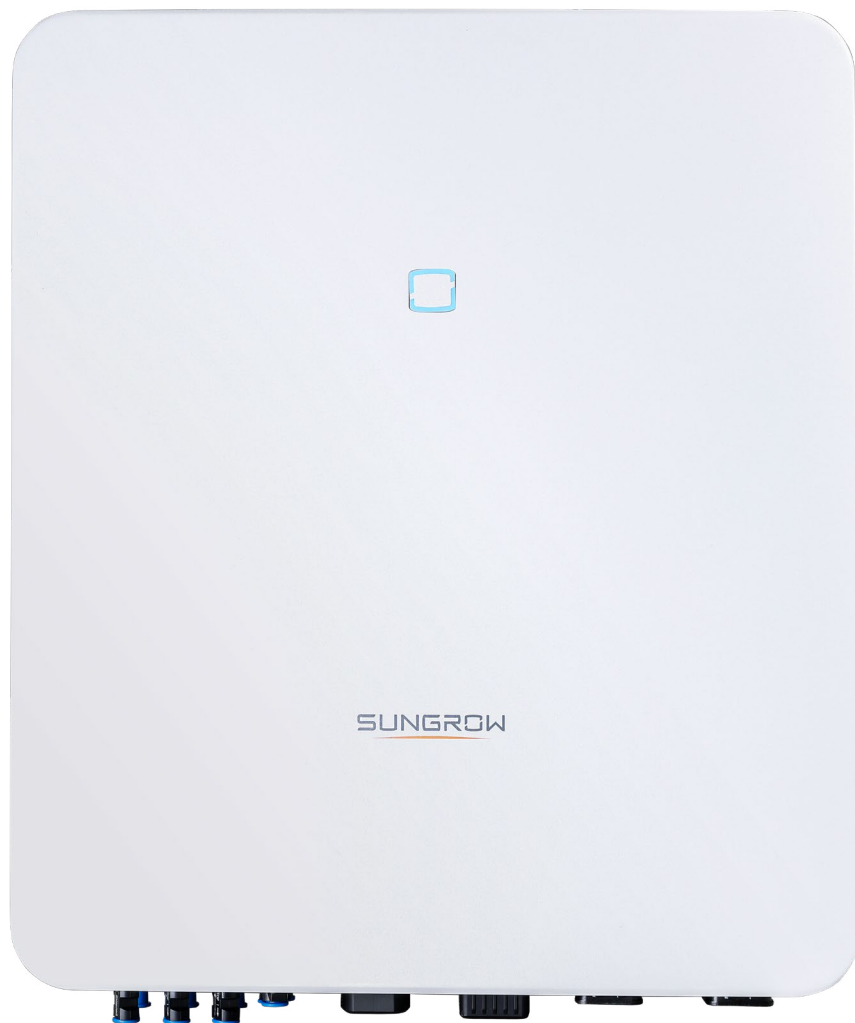



INSTALLATION & INBETRIEBNAHME MIT LG BATTERIE

1 BATTERIE ÖFFNEN

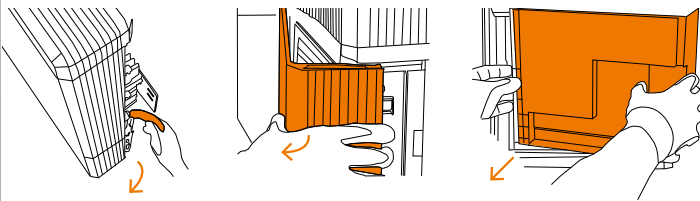

2 BATTERIE ANSCHLIESSEN

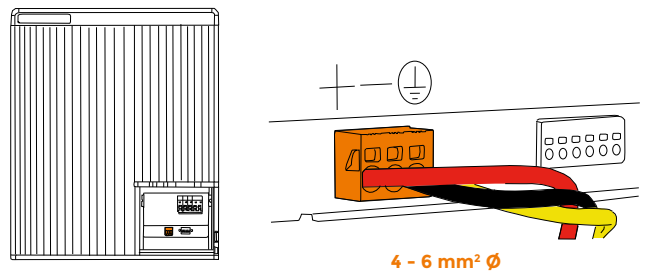

3 KABELPOLARITÄT ÜBERPRÜFEN

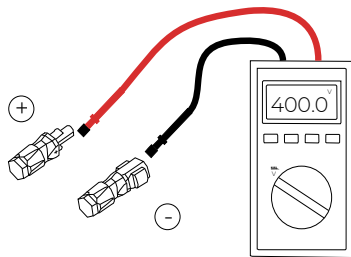

4 SUNCLIX ZUSAMMENBAUEN

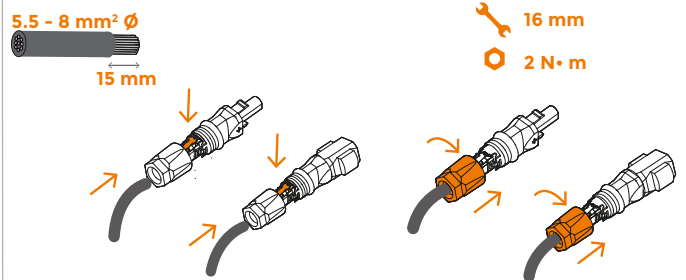

5 WECHSELRICHTER VERBINDEN

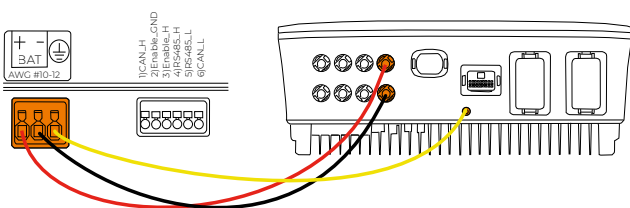

6 KOMMUNIKATION HERSTELLEN

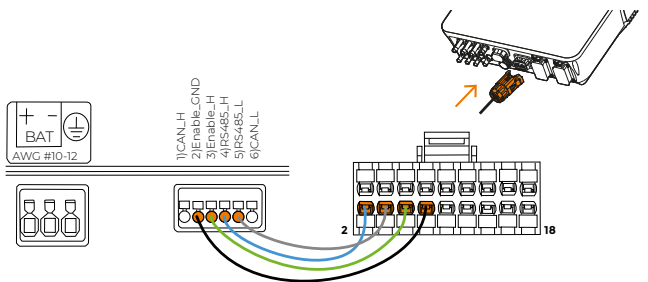

7 BATTERIE EINSCHALTEN

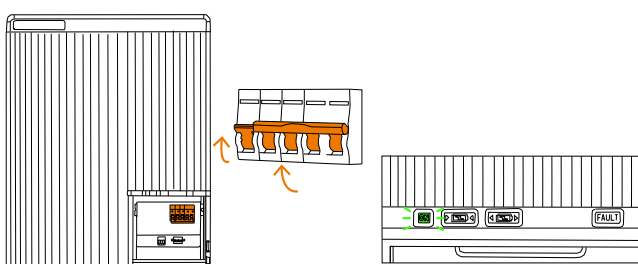

8 iSolarCloud ÖFFNEN



10 min.

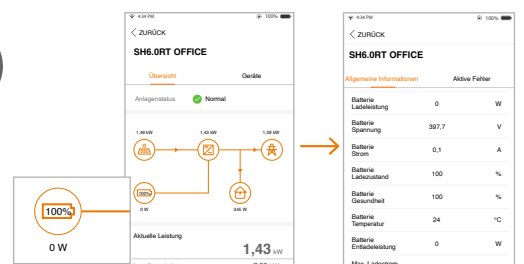



INSTALLATION & INBETRIEBNAHME MIT BYD BATTERIE

1 BATTERIE ANSCHLIESSEN

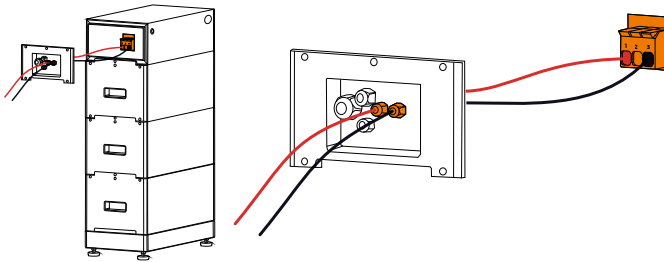

2 ERDUNG VERBINDEN

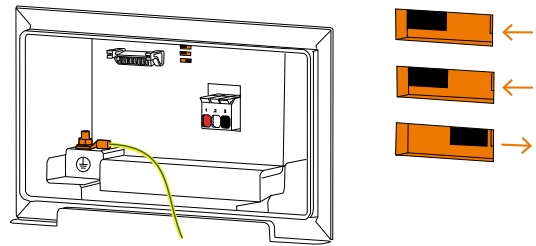

3 KABELPOLARITÄT ÜBERPRÜFEN

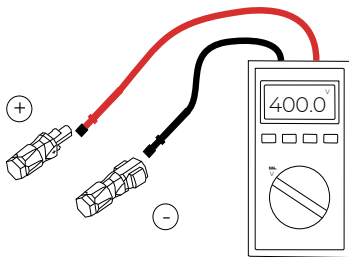

4 SUNCLIX ZUSAMMENBAUEN

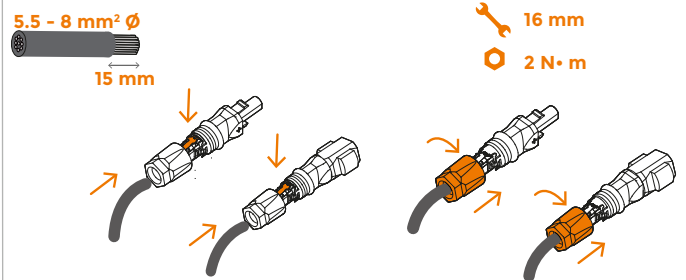

5 KOMMUNIKATION HERSTELLEN

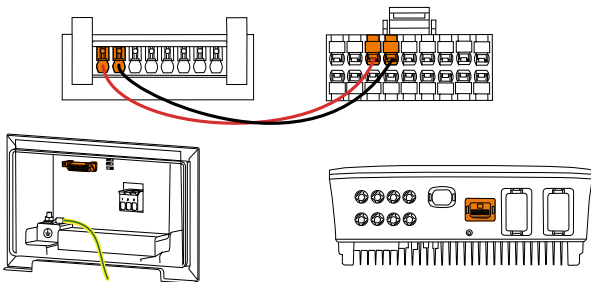

6 BATTERIE EINSCHALTEN

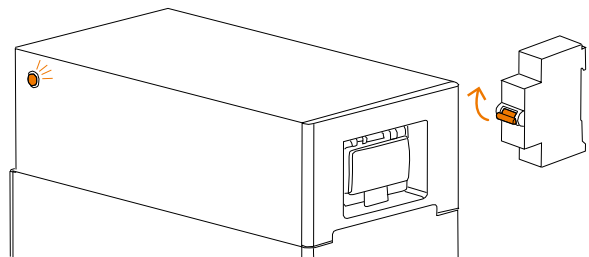

7 BYD Be Connect EINRICHTEN

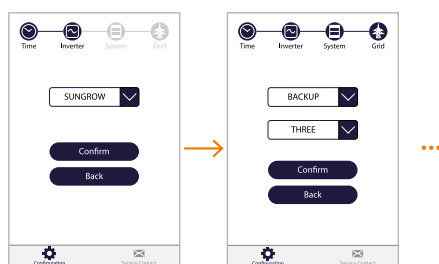

8 iSolarCloud ÖFFNEN

