



Schnellinstallation

— X1 Serie 2.5kw - 3.3kw

II

Inverter Montage

1 - Markieren Sie die 3 Löcher

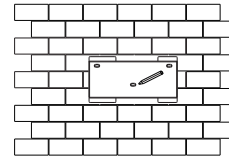

2 - Bohren Sie mit einem 6mm Bohrer
- Mindesttiefe 50 mm

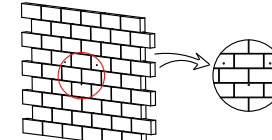

3 - Dübel befestigen

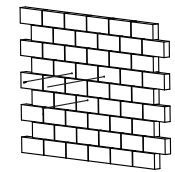

4 - Halterung befestigen

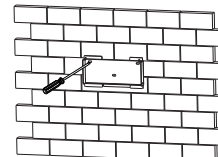

5 - Hängen Sie den Inverter an die Halterung
- Fixieren Sie ihn mit der Kreuzschlitzschraube auf der rechten Seite.

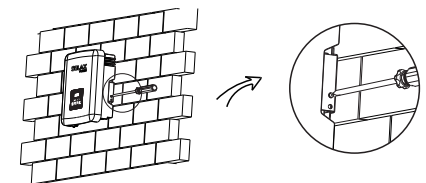

I

Verpackungsliste

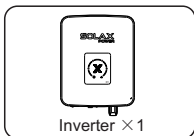

Inverter × 1

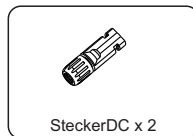

SteckerDC x 2

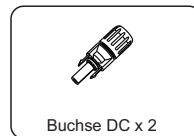

Buchse DC x 2

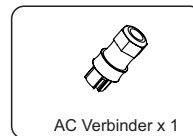

AC Verbinder x 1

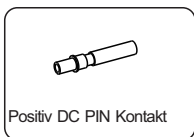

Positiv DC PIN Kontakt

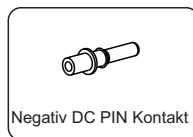

Negativ DC PIN Kontakt

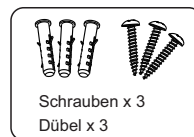

Schrauben x 3
Dübel x 3

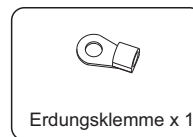

Erdungsklemme x 1



Garantieschein



Produkt Handbuch



Schnellstartanleitung

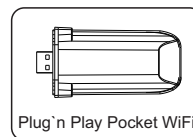

Plug'n Play Pocket WiFi

III

PV Installation

Kabelquerschnitt 12 AWG
Abisolierung:

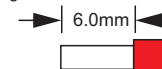

-Anordnung der Kupplung

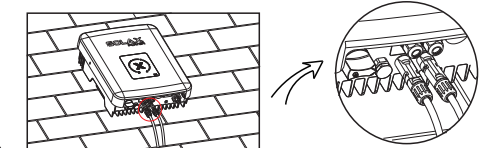

Positiver DC
PIN Kontakt

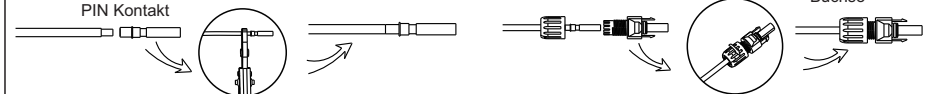

Buchse

Kabel
negativer DC
PIN Kontakt

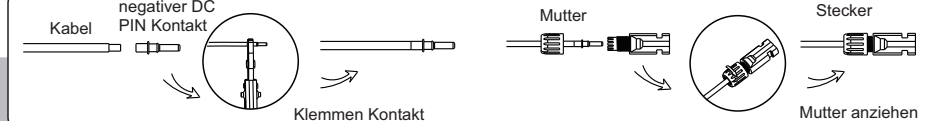

Klemmen Kontakt

Mutter

Stecker

Mutter anziehen

IV

AC Anschluss

Kabelquerschnitt 10 AWG

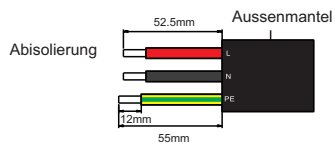

1. Mutter und Deckel über Kabel ziehen



Kabel in Buchse einführen und befestigen

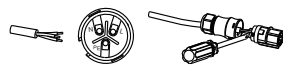

3. Gehäuse und Mutter befestigen

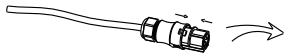

4. Ziehen sie die Mutter an

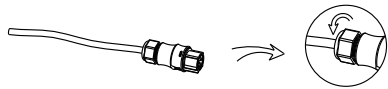

AC-Verbinder mit dem Inverter verbinden

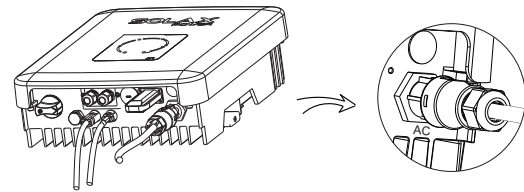

VI

USB für Update

- Öffnen Sieden Deckel für den USB Anschluss

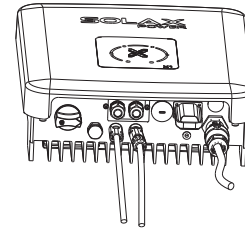

- Stecken Sie den USB-Stick mit dem Programm in den USB-Port

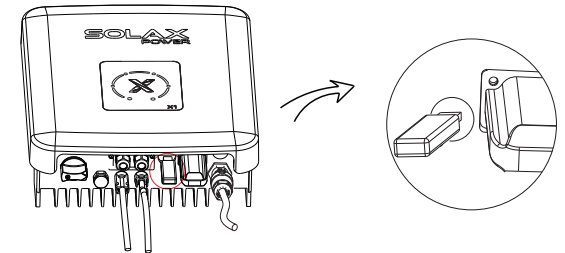

V

WiFi Anschluss (optional)

Öffnen Sie den WiFi Deckel unten am Gehäuse

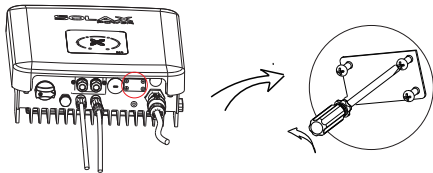

Stecken Sie den Pocket-WiFi (von Solax) in die WiFi Buchse und ziehen Sie die Schrauben vorsichtig an.

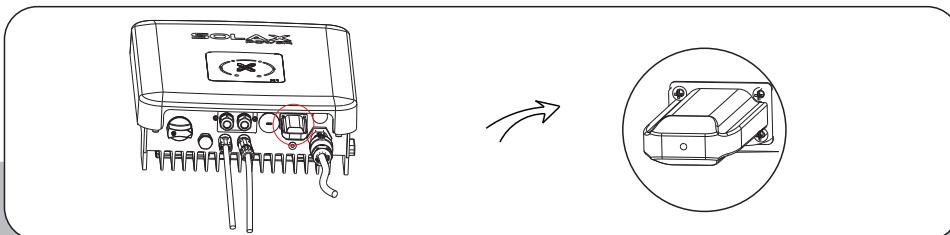
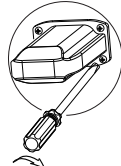

VII

Anschlussübersicht



Warnung !
Schutzleiter muss angeschlossen sein !

- Befestigen Sie die Schutzleiterschraube mit einem Innensechskantschlüssel

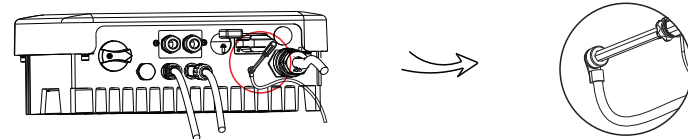

- Übersicht der Anschlüsse

